

This drawing is copyright:
 1. Do not scale this drawing.
 2. Errors and omissions to be immediately notified to the Architect.
 3. All dimensions to be checked on site.

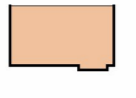

© Ordnance Survey Ireland and Government of Ireland
 Licence No. AR003819
 Sheet No's: MH025, MH031, 9900-21

House Type E2		3 bedroom	- 1
House Type N2		3 bedroom	- 9
House Type N3		3 bedroom	- 3
House Type N7		2 bedroom	- 6
House Type F1		4 bedroom	- 1
Corner Block CB5A: (2 no. 3 bed maisonettes, 1 no. 2 bed maisonette, 1 no. 2 bed simplex apartment & 1 no. 1 bed simplex apartment)		1 bedroom - 1 2 bedroom - 2 3 bedroom - 2	
Duplex Units:		2 bedroom - 5 3 bedroom - 5	
Apartment Blocks:		1 bed apartment - 7 2 bed apartment - 12	
Total Part V Units			- 54 (10%)

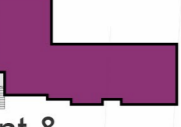
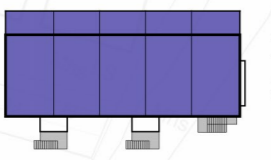
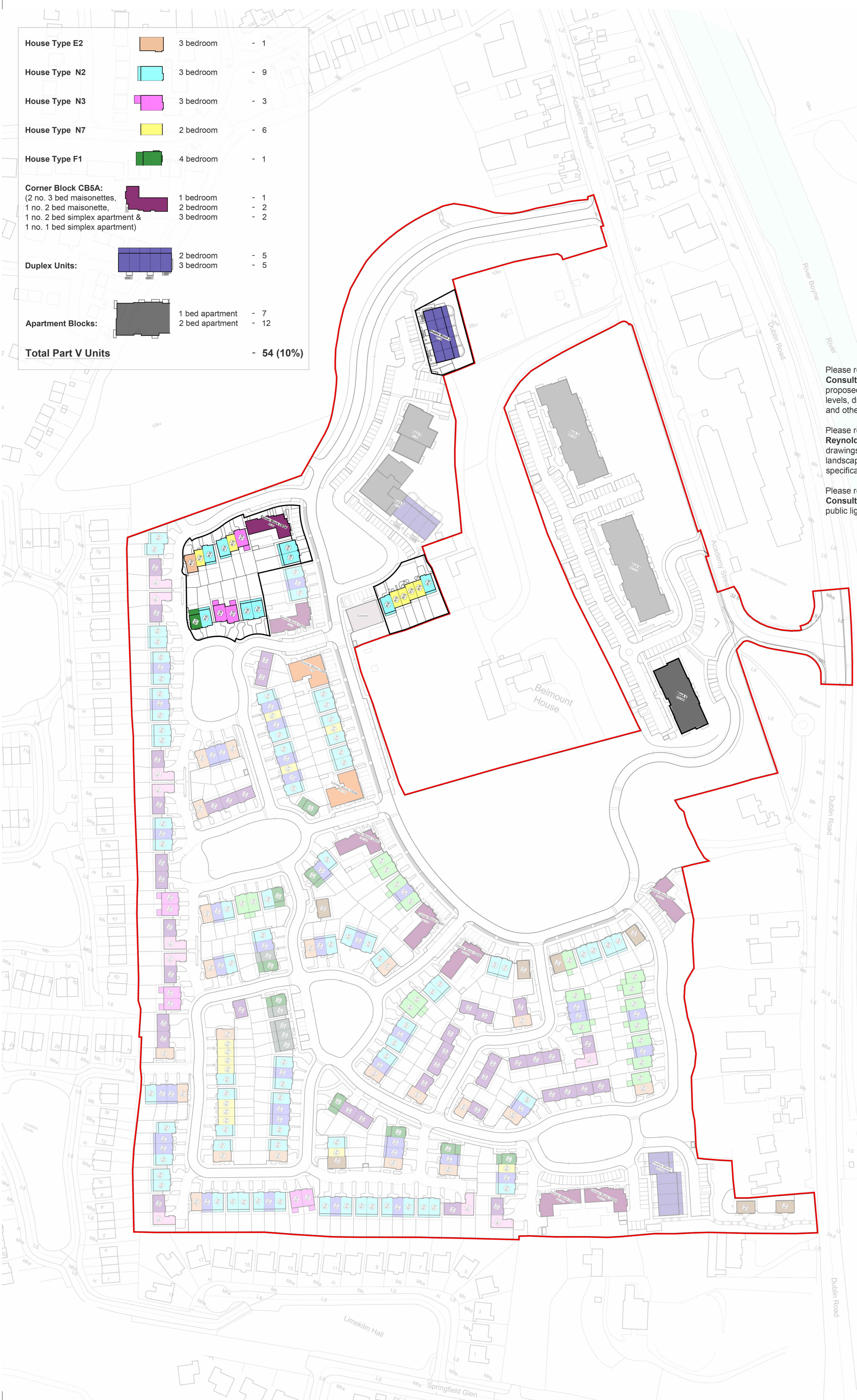

Please refer to **Cronin & Sutton Consulting Engineers'** drawings for proposed finished floor levels, road levels, drainage and attenuation details and other engineering works.

Please refer to **Cunnane Stratton Reynolds Land Planning & Design** drawings for surface finishes, landscaping details, planting details and specification and boundary details.

Please refer to **Morley Walsh Consulting Engineers'** drawings for public lighting layout.

revisions	description	date info
	Site Layout Part V	
job	Development at Academy Street Navan	1828 P 111
client	Coindale Ltd.	
issue	Planning	
CONROY CROWE KELLY ARCHITECTS		
65 MERRION SQUARE DUBLIN 2		
PHONE: 6613990 FAX: 6765715		
E-MAIL: info@ckk.ie		